

8146/1000-C958 Art. No. 136170



- Cable end boxes for terminals up to 185 mm<sup>2</sup>
- Degree of protection IP66
- Rated operational current depending on enclosure version up to 400 A

MY R. STAHL 8146B



R. STAHL Series 8146 cable end boxes comprise robust glass fibre reinforced Ex e enclosures. They are equipped with terminals up to 185 mm<sup>2</sup>. These are suitable for voltages up to 690 V, the rated operational current is max. 400 A depending on the enclosure version. The incoming and outgoing leads are fed into the enclosures via cable glands.

## Technical Data

### Explosion Protection

|                                 |  |
|---------------------------------|--|
| Area of application             | IECEX<br>European Union (ATEX)             |
| Application range (zones)       | 1, 2, 21, 22                               |
| IECEX gas certificate           | IECEX PTB 06.0046                          |
| IECEX gas explosion protection  | Ex eb IIC T6 ... T4 Gb                     |
| IECEX dust certificate          | IECEX PTB 06.0046                          |
| IECEX dust explosion protection | Ex tb IIIC T80 °C ... T130 °C Db           |
| ATEX gas certificate            | PTB 01 ATEX 1016                           |
| ATEX gas explosion protection   | ⊕ II 2 G Ex eb IIC T6 ... T4 Gb            |
| ATEX dust certificate           | PTB 01 ATEX 1016                           |
| ATEX dust explosion protection  | ⊕ II 2 D Ex tb IIIC T80 °C ... T130 °C Db  |
| Certificates                    | ATEX (PTB), Canada / USA (UL), IECEX (PTB) |

### Electrical Data

|                                |                          |
|--------------------------------|--------------------------|
| Rated operational voltage AC   | 690 V                    |
| Rated operational current max. | 125 A / T6<br>160 A / T5 |

### Ambient Conditions

|                     |   |
|---------------------|---|
| Ambient temperature | -30 °C ... +40 °C (T6)<br>-30 °C ... +45 °C (T5) (T4) |
|---------------------|---|

### Mechanical Data

|                                     |   |
|-------------------------------------|---|
| Degree of protection IP (IEC 60529) | IP66                                    |
| Enclosure material                  | Polyester resin, Glass fibre reinforced |
| Enclosure colour                    | Dark grey                               |
| Flammability according to           | IEC/EN 60695<br>UL 94<br>ASTM D635      |
| Silicone-free                       | No                                      |
| Connection cross-section            | 70 mm <sup>2</sup>                      |

8146/1000-C958 Art. No. 136170

#### Mechanical Data

|                           |           |
|---------------------------|-----------|
| Cover thickness           | 2.8 mm    |
| Cover thickness in inches | 0.11 in   |
| Wall thickness            | 2.8 mm    |
| Wall thickness in inches  | 0.11 in   |
| Width                     | 340.5 mm  |
| Width, inches             | 13.406 in |
| Height                    | 512 mm    |
| Height in inches          | 20.158 in |
| Depth                     | 150 mm    |
| Depth in inches           | 5.906 in  |
| Weight                    | 9.5 kg    |
| Weight                    | 20.94 lb  |

#### Mounting / Installation

|   |              |
|---|--------------|
| Tightening torque lbf in                  | 0 lbf-in     |
| Tightening torque of cover screw 1        | 4.5 N · m    |
| Tightening torque of cover screw 1 lbf in | 39.83 lbf in |

#### Components

|                        |   |
|------------------------|---|
| Entry 1                | 2 x Threaded holes<br>without cable entry<br>M75              |
| Terminal rail          | 35 x 301 mm (1x)  |
| Terminal rail          | 1.38 x 11.85" (1x)  |
| Type of terminals 1    | 6 x Weidmüller WDU<br>2-conductor, 95 mm <sup>2</sup> , beige |
| Type of terminals PE 1 | 2 x Weidmüller WDU<br>2-conductor 95 mm <sup>2</sup> beige    |

#### Technical Drawings – Subject to Alterations

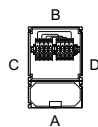

8146/1000-C958 Art. No. 136170

Dimensional Drawings (All Dimensions in mm [inches]) – Subject to Alterations

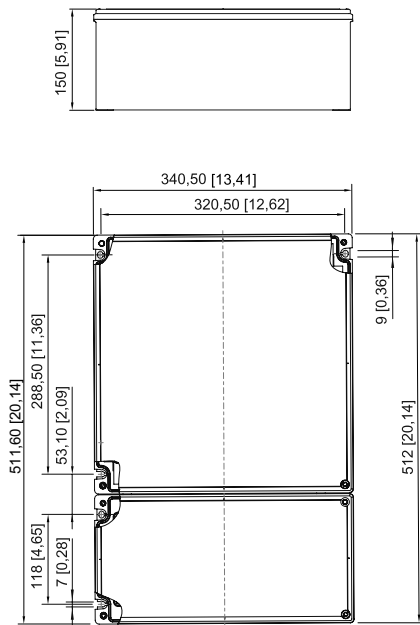

8146/1000-C958

We reserve the right to make alterations to the technical data, dimensions, weights, designs and products available without notice. The illustrations cannot be considered binding.