

8703 PUSHBUTTON ASSEMBLY

Contact Block Information

DESCRIPTION	CONTACT SYMBOL		INDIVIDUAL ORDER CATALOG NUMBER
	IEC	NEMA	
Single contact block, 1 NC			8082/1-1-00
Single contact block, 1 NO			8082/1-2-00

Technical Data of Contact Block

	NEC/CEC	IEC
Rated Voltage	600VAC	500VAC
Continuous Current	10A	6A
Terminals	12AWG	2.5mm ²
Mechanical Life	≥ 106 operations	
Electrical Life	≥ 106 operations	
Housing Material	polyamide	
Contact Material	silver plated	
Lowest Energy	50mA. @ 12V*	



Enclosure Type Rating For Installation

Area Classification of Use	Pushbutton 8703
Class I Zone 1	Enclosure AEx e/Ex e
Class I Division 2 Groups A, B, C, D	Enclosure Type 1, 2, 3, 3R, 4, 4X, 12, 13
Class II Division 2 Groups F, G	Enclosure Type 3, 4, 4X, 12, 13
Class III	Enclosure Type 3, 4, 4X, 12, 13

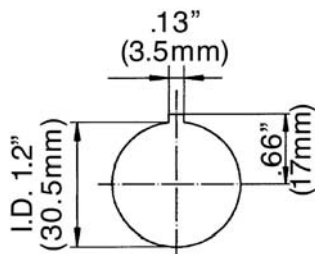

Knockout for 8703

Ordering Information

PUSHBUTTON CONTACTS	CATALOG NUMBER
1 NC	8703/01 - <input type="text"/> <input type="text"/> - 9
1 NO	8703/02 - <input type="text"/> <input type="text"/> - 9
1 NC / 1 NO	8703/12 - <input type="text"/> <input type="text"/> - 9
2 NC	8703/11 - <input type="text"/> <input type="text"/> - 9
2 NO	8703/22 - <input type="text"/> <input type="text"/> - 9

Fill out the blanks in the Catalog Number with the information found on pages F15 or F16 in the column "ACTUATOR CODE" (actuator code 23 not possible).



CLASSIFICATIONS for Contact Block 8082/1 and Actuator 8602

NEC- Class I, Zones 1 & 2 AEx de IIC T6
Class I, Division 2, Groups A,B,C,D
Class II, Division 2, Groups F,G
Class III
Environmental Protection 3, 4, 4X;
IP66 Front, depending on enclosure
(see table - "Enclosure Type Rating For Installation")

File No. E182378

CEC- Class I, Zones 1 & 2 Ex de IIC T6
Class I, Division 2, Groups A,B,C,D
Class II, Divisions 2, Groups F,G
Class III

FILE No. LR99480

II 2 G Ex de IIC
PTB 00 ATEX 1031 U
PTB 01 ATEX 1129 U

Ambient Temperature Range:
+55°C (+131°F) Max.
-25°C (-13°F) Min.

IECEX
Ex de IIC
IECEX PTB 06.0011 U
IECEX PTB 06.0014 U

FEATURES:

The 8703 pushbutton assembly consists of contact block(s) 8082/1, one mounting bracket and one actuator 8602 - as listed on page F715.

The contact blocks have a single contact either 1 NC or 1 NO.

The terminals are accessible from the front, therefore the wires need to be connected before the contact block is snapped into the b

