



- Highly resistant industrial design
- Linear luminaire with long-life, efficient LED technology (up to 138 lm/W)
- Lightweight yet extremely robust, with an impact strength rating of IK10

## MY R. STAHL L402A

The EXLUX L402/4 luminaire is designed for industrial use and can be fitted to the ceiling, a pole, or alternatively, it can be suspended. A bright light for not much energy is what you get with this efficient LED technology, which offers the added benefit of increased service life – this can be as much as 100,000 hours. The plastic enclosure is easily to open by a central lock.

Selection Table								
Size		2						
Light distribution		120°x120° with diffusing glass						
Lamp wattage		22 W						
Luminous flux		2910 lm						
Luminaire efficacy		132 lm/W						
Translucent cover	Light colour	Disconnection of the luminaire	Diffuser	Drilled holes	Threaded plate	Product Type	Art. No.	Weight
Clear	5000 K – neutral white	No	With diffuser	3 x M25	2x plastic	L402/4328-6100-152-1110-11-8500	271366	3.2 kg
		No	With diffuser	3 x M20	2x SS430 stainless steel	L402/4328-6100-152-2220-22-8500	271367	3.3 kg
Size		4						
Light distribution		120°x120° with diffusing glass						
Lamp wattage		42 W						
Luminous flux		5810 lm						
Luminaire efficacy		138 lm/W						
Translucent cover	Light colour	Disconnection of the luminaire	Diffuser	Drilled holes	Threaded plate	Product Type	Art. No.	Weight
Clear	5000 K – neutral white	No	With diffuser	3 x M25	2x plastic	L402/4348-6100-152-1110-11-8500	271364	5.6 kg
		No	With diffuser	3 x M20	2x SS430 stainless steel	L402/4348-6100-152-2220-22-8500	271365	5.7 kg
Size		6						
Light distribution		120°x120° with diffusing glass						
Lamp wattage		50 W						
Luminous flux		6960 lm						
Luminaire efficacy		139 lm/W						
Translucent cover	Light colour	Disconnection of the luminaire	Diffuser	Drilled holes	Threaded plate	Product Type	Art. No.	Weight
Clear	5000 K – neutral white	No	With diffuser	3 x M25	2x plastic	L402/4368-6200-152-1110-11-8500	285176	7 kg
<p><b>Variants with 2 x threaded plate plastic and 3 x drilled holes M25:</b> Cable glands 2 x M25 Ø 7-17 mm and 2 x stopping plugs M 25 x 1,5 are included loose with the product (installation required). Threaded plate included.</p> <p><b>Variants with 2 x threaded plate stainless steel SS430 and 3 x drilled holes M20:</b> Cable glands and stopping plugs can be ordered as accessories. Threaded plate included.</p> <p>The light fittings are supplied without mounting material.</p>								

## Technical Data

### Electrical Data

Rated operational voltage AC	100 ... 240 V
Rated operational voltage DC	200 ... 250 V

### Ambient Conditions

Ambient temperature	-40 °C ... 55 °C Note: Through wiring Max. 3x16 A -40 °C ... 60 °C Note: Through wiring 2 Max. 3x10 A
---------------------	--

### Lighting Data

Lamp	LED
Colour rendering	≥ 80
Colour temperature	5000 K

### Mechanical Data

IP degree of protection (IEC 60598)	IP66/IP67
Class	I (with inner PE connection)
Enclosure material	Polyester resin, Glass fibre reinforced
Sealing material	Silicone
Translucent cover material	Polycarbonate
Installed terminal strip	PE + N + L1 + L2 + L3
Max. solid connection terminals	6 mm <sup>2</sup>
Type of connection cable	Finely stranded Solid
Impact strength (IEC 62262)	IK10
Enclosure colour	Light grey (RAL 7035)
Notes	Connection terminals: Spring clamp terminal (2 free clamping units per pole available)



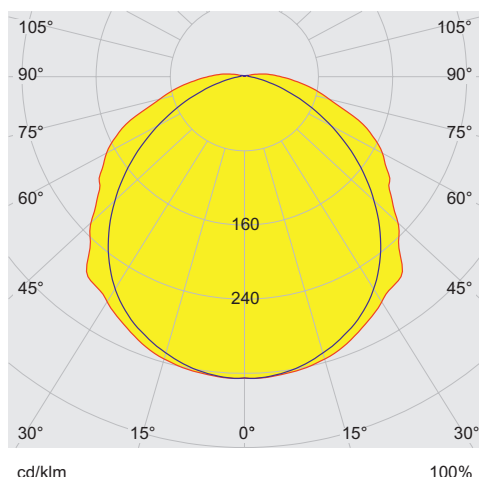

### Components

Ballast	VG Luxtronic 40 W 300 mA
Through wiring	With 5 conductors 2.5 mm <sup>2</sup>

## Light Distribution Curves – Subject to Alterations

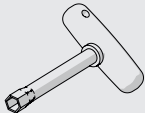
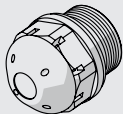
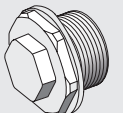
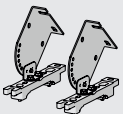

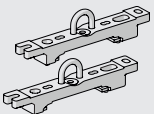
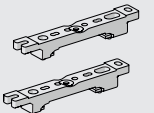
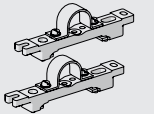
cd/klm  
— C0 - C180      — C90 - C270  
 typical with diffusor, clear translucent cover

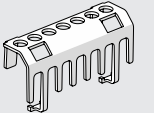
Accessories			
Figure	Description	Art. No.	Weight
<b>Box spanner</b>			
	M8 / A/F 13; For actuating the central lock	222430	110 g
<b>Breather</b>			
	Thread: M25 x 1.5 (20 pieces); without jam nut	285780	200 g
	M25 x 1.5 in order to avoid condensate formation	115738	17 g
	Thread: M25 x 1.5 (1 piece); for installation in light fittings; made from stainless steel; without jam nut	296608	76 g
<b>Ceiling and wall mounting bracket</b>			
	mounted on a mounting rail for a variable mounting distance; Material: stainless steel; Lamp can be swiveled in steps of 15°; 1 pair	222827	1.2 kg
<b>Holder for translucent cover</b>			
	The fall prevention system for the light fitting cover prevents the light fitting cover from falling accidentally when the light fitting is opened.	226791	21 g
<b>Mounting bracket</b>			
	mounting clamp mounted on a mounting rail for a variable mounting distance; 1 pair	222456	400 g
<b>Mounting rail</b>			
	for a variable mounting distance; 1 pair	222826	350 g
<b>Pipe clamp</b>			
	R 1 1/2"; with mounting rail for a variable mounting distance; material: stainless steel; 1 pair	222459	700 g
	R 1 1/4"; with mounting rail for a variable mounting distance; Material: stainless steel; 1 pair	222458	700 g
	R 2"; with mounting rail for a variable mounting distance; Material: stainless steel; 1 pair	222460	750 g
<b>Pole mounting sleeve</b>			
	for the subsequent mounting on lights size 2 and size 4, completely with assembly parts (for pipe diameter 42 mm)	227512	3.2 kg
<b>Protection against accidental contact</b>			
	The protection against accidental contact prevents maintenance technicians and electrical installers from accidentally touching conductive parts. The degree of protection is increased to IP20 when the protection against accidental contact is used.	283153	14 g

### Accessories

Figure	Description	Art. No.	Weight
Ring bolt			
	M8, direct mounting in insert nuts; 1 pair	115736	115 g

### Spare Parts

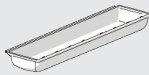
Figure	Description	Art. No.	Weight
Cover			
	for luminaire size 4	222428	1.15 kg
	for luminaire size 6	222429	1.45 kg
	for luminaire size 2	222427	639 g

### Dimensional Drawings (All Dimensions in mm [inches]) – Subject to Alterations

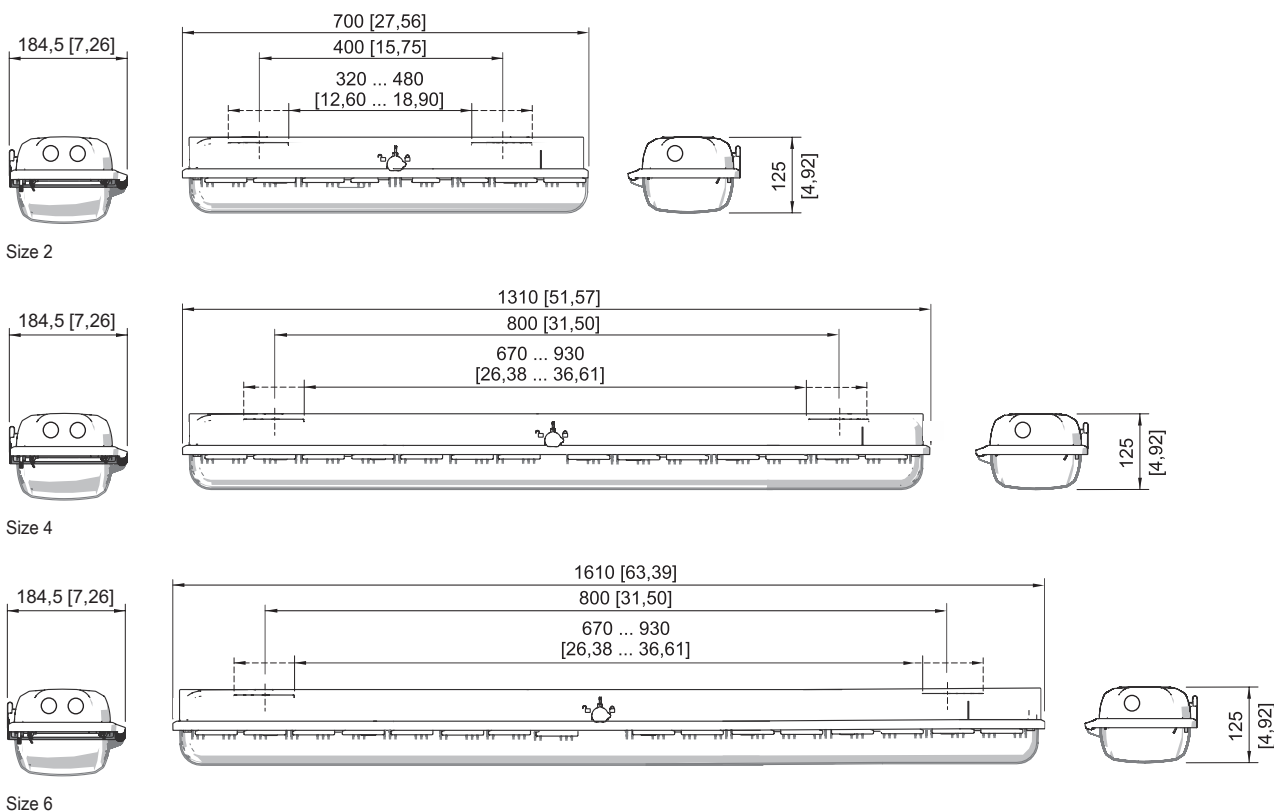

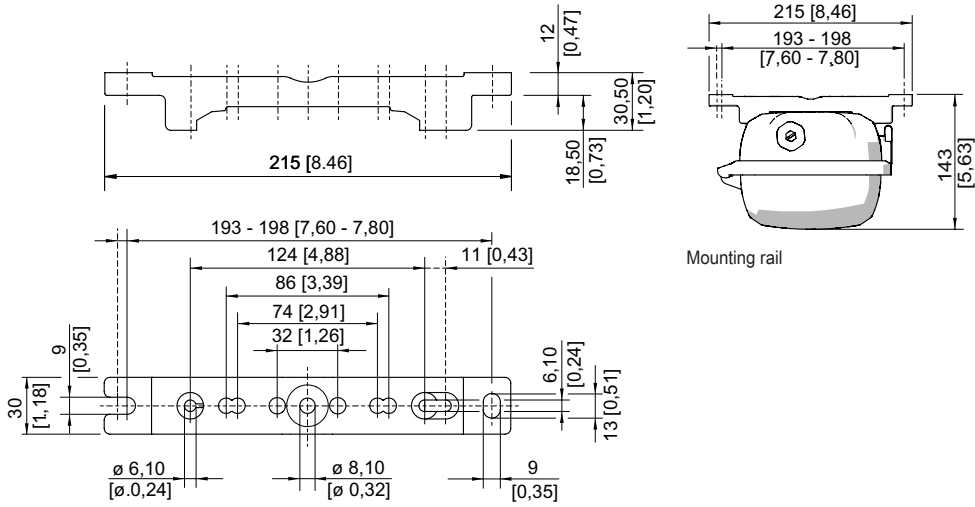

Mounting rail

Mounting rail

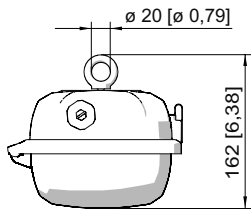

Ring bolt fitted in insert nut of the luminaire

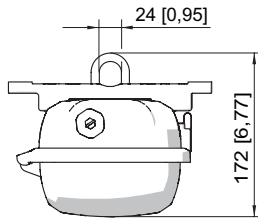

Mounting bracket fitted in mounting rail

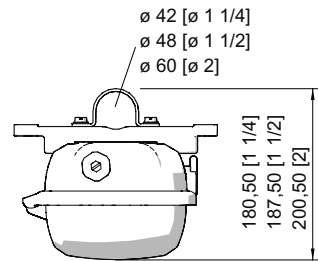

Pipe clamp fitted in mounting rail

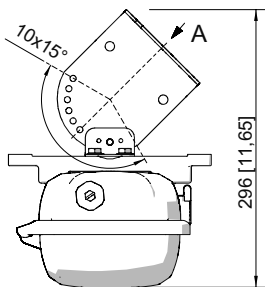

A

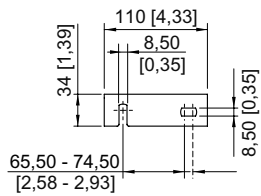

Wall mounting bracket fitted in mounting rail